

MQS Contact Protection

GPN 363



www.poeppelmann.com/en/gpn363



Application

The GPN 363 MGS contact protection is used to protect MGS flat connector housings in the low-voltage range. The handy grip tab ensures quick removal and the circumferential ribs enable an optimum clamping fit. The MGS contact protection offers protection against splashing water from all directions (IPX4) depending on the specific connector design and quality.

All information about 100% PCR and the recycling blend can be found in "Sustainability at Pöppelmann" (see chapter 2) or at www.poeppelmann.com/en/kapsto/Responsibility.html

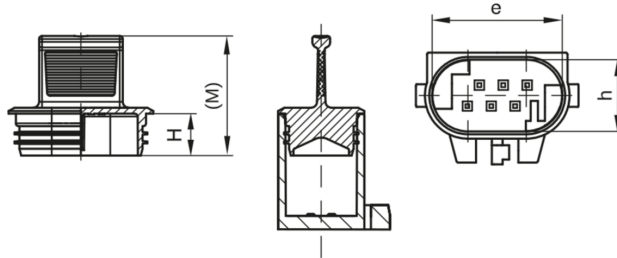

PCR-PE
blue



PCR-PE / PE-LD
yellow



PE-LD
yellow

Article	e	h	H	M	100% PCR	Recycling blend	Virgin material
GPN 363 KS 0211*	12,3	8,3	7	20			36302110000
GPN 363 KS 0321	14,4	10,75	7	20	3630321RB61	36303210073	36303210000
GPN 363 KS 0421	17,5	10,75	7	20	3630421RB61	36304210073	36304210000
GPN 363 KS 0621	21,8	12	7	20	3630621RB61	36306210073	36306210000
GPN 363 KS 0821	23,4	15,7	7	20	3630821RB61	36308210073	36308210000

Dimensions in mm.

*Item GPN 363 KS 0211 is made of PE-LLD.

Information on materials, colours, designs and use of our products can be found on the website and in chapter 3 'Materials and application'.

The articles in the 100% PCR column consist of 98% PCR-PE and 2% colour based on a PIR carrier. The plastic used consists of 100% PCR.

The articles in the recycled mixture column consist of a blend of PCR and virgin material. Colour deviations and black dots cannot be completely avoided during production and are permissible for these items. We recommend carrying out functional tests before series production.

Guide values for low-voltage applications

Article	Contact connections	Manufacturer	Number of poles	Rows
GPN 363 KS 0211*	MQS 0.63	TE Connectivity	2	1
GPN 363 KS 0321	MQS 0.63	TE Connectivity	3	2
GPN 363 KS 0421	MQS 0.63	TE Connectivity	4	2
GPN 363 KS 0621	MQS 0.63	TE Connectivity	6	2
GPN 363 KS 0821	MQS 0.63	TE Connectivity	8	2

The contact protector GPN 363 was developed for special MGS connector housings listed in the application table. The contact protector is also suitable for other connections.

** Related to Pöppelmann sample connector, tested according to DIN 40050. Please note the information in chapter 3 Materials and applications.

MQS Contact Protection

GPN 363



www.poeppelmann.com/en/gpn363

Your added values:



More resource-saving.

This standard series is available from PCR, saves CO₂e emissions and conserves resources.



Better fit.

Protection for MQS flat connector housings.



Saves time.

With practical tab for fast removal.



Seals better.

Protection against splashing water from any direction (IPX4) depending on the specific connector design and quality. Related to Pöppelmann sample connector, tested according to DIN 40050.*



Cleaner.

Production in accordance with VDA Band 19 and ISO 16232 in our cleanroom on request.



Better.

Circumferential ribs for perfect design fit.