

# Grease Nipple Caps GPN 985 Type A



[www.poeppelmann.com/en/gpn985a](http://www.poeppelmann.com/en/gpn985a)

## Application



The grease nipple caps GPN 985 type A are suitable for protecting tapered grease nipples pursuant to DIN 71412. The outer wall is knurled for a good grip for easier assembly and disassembly.

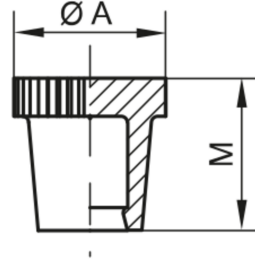

PE-LLD  
yellow

Article	Colour	A	M	Virgin material
GPN 985 / 0100	yellow	12	12	98501000000
GPN 985 / 0101	red	12	12	98501010000
GPN 985 / 0102	green	12	12	98501020000
GPN 985 / 0103	black	12	12	98501030000

Dimensions in mm.

Information on materials, colours, designs and use of our products can be found on the website and in chapter 3 'Materials and application'.

## Your added values:



**Better fit.**

Protection for the tapered heads of grease nipples in accordance with DIN EN 71412.



**Better.**

Protect the tapered head of grease nipples against contamination and visibly mark lubrication points. Caps are knurled for ease of grip.